

STATE OF NORTH CAROLINA  
DEPARTMENT OF TRANSPORTATION  
HIGHWAY DIVISION 6

# PLANS

**Letting Date: June 7, 2023**

**CONTRACT ID: DF00442**

**TIP NO.: -----**

**FEDERAL AID NO.: -----**

**WBS ELEMENT NO.: 2023CPT.06.15.10431.1**

**ROUTE NO.: Various**

**LOCATION: Various**

**COUNTY: Harnett**

**LENGTH OF PROJECT: 22.93 Miles**

**TYPE OF WORK: Resurfacing, Widening, Milling, & Pavement Markings**

**This electronic collection of documents is provided  
for the convenience of the user  
and is Not a Certified Document –**

**The documents contained herein were originally issued  
and sealed by the individuals whose names and license  
numbers appear on each page, on the dates appearing  
with their signature on that page.**

**This file or an individual page  
shall not be considered a certified document.**

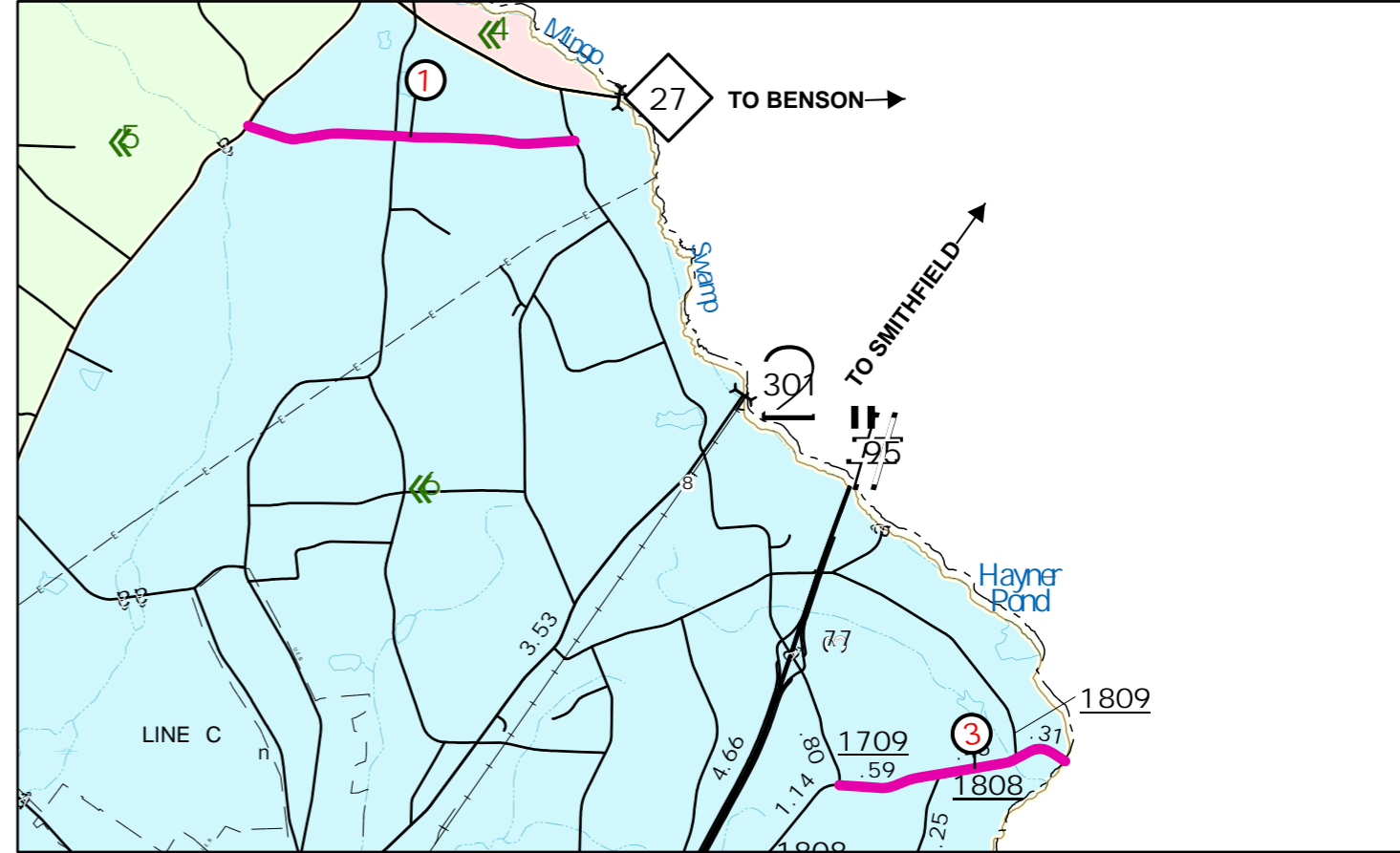
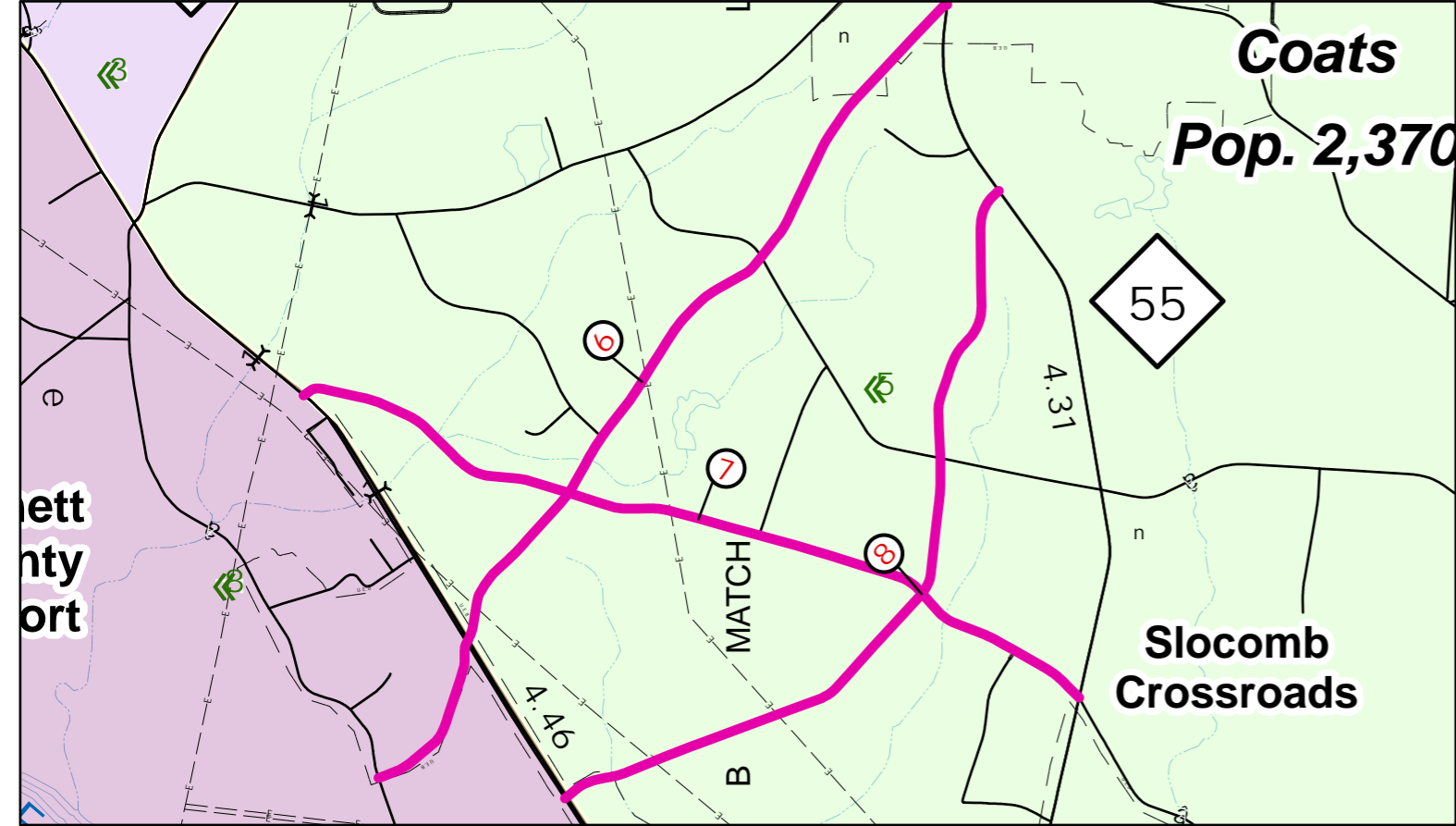

# Harnett County Preservation and Resurfacing

WBS: 2023CPT.06.15.20431.1

Contract Number: DF00442

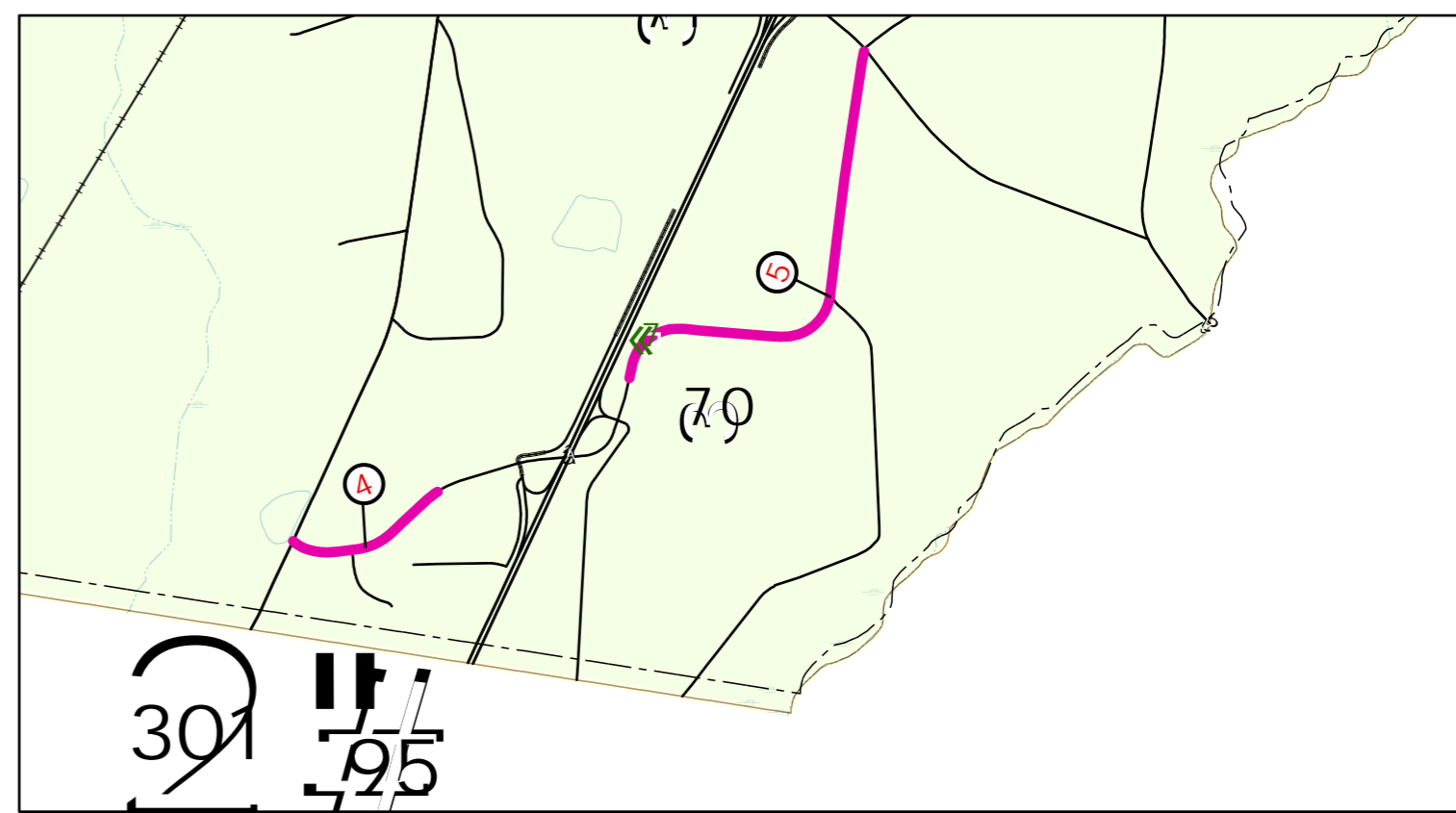
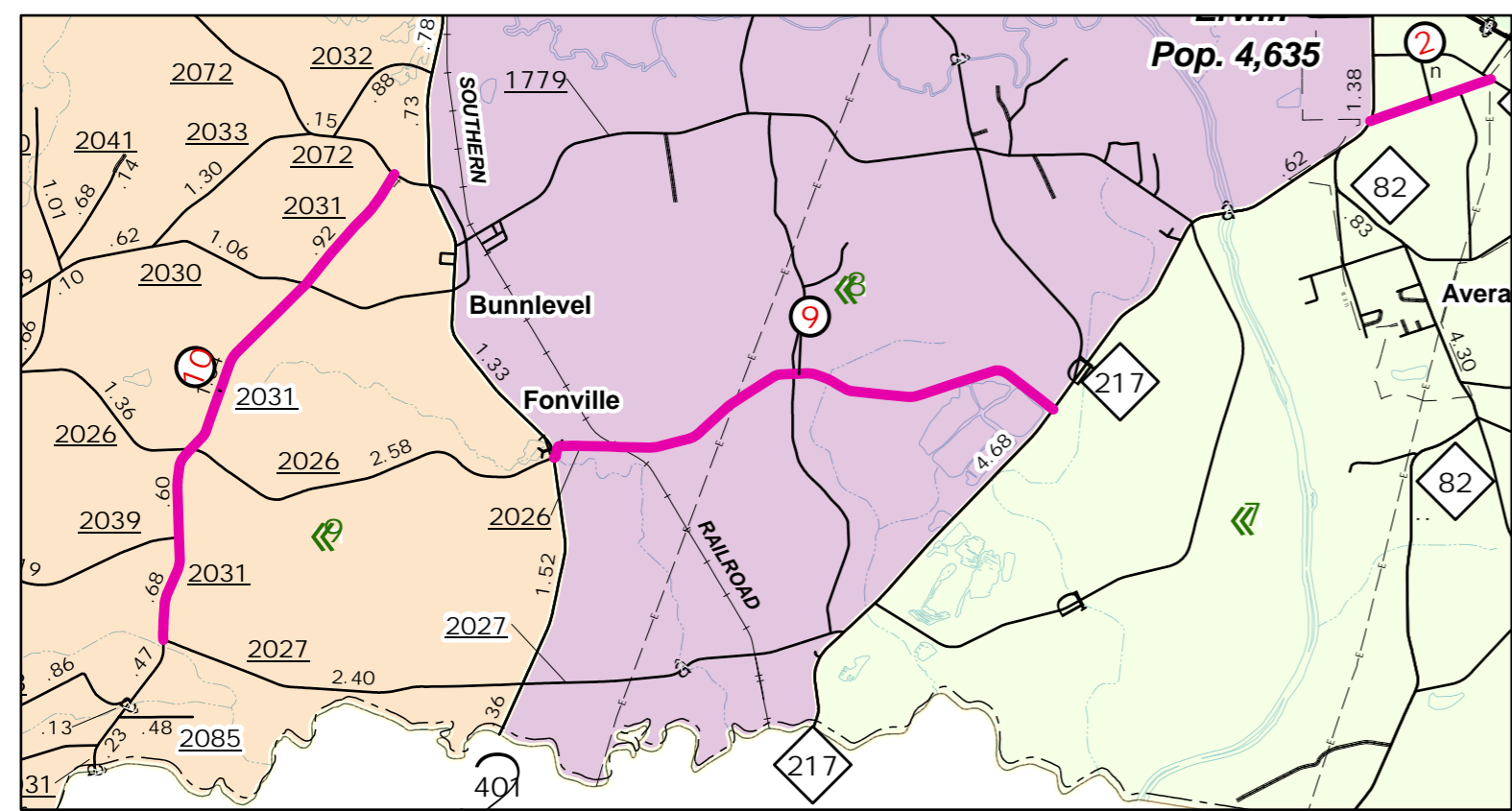
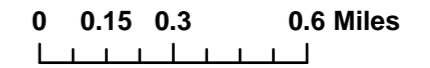

# PAVEMENT SCHEDULE

|    |   |
|----|---|
| C1 | 1½" ASPHALT CONCRETE SURFACE COURSE, TYPE S9.5B, AT AN AVERAGE RATE OF 168 LBS. PER SQ. YD.       |
| D1 | 2½" ASPHALT CONCRETE INTERMEDIATE COURSE, TYPE I19.0C, AT AN AVERAGE RATE OF 285 LBS. PER SQ. YD. |
| E1 | 5½" ASPHALT CONCRETE BASE COURSE, TYPE B25.0C, AT AN AVERAGE RATE OF 627 LBS. PER SQ. YD.         |
| T1 | SHOULDER RECONSTRUCTION WITH AGGREGATE SHOULDER BORROW  |
| U  | EXISTING ASPHALT PAVEMENT   |
| V1 | 0"-1½" MILLING  |
| V2 | 1½" MILLING   |

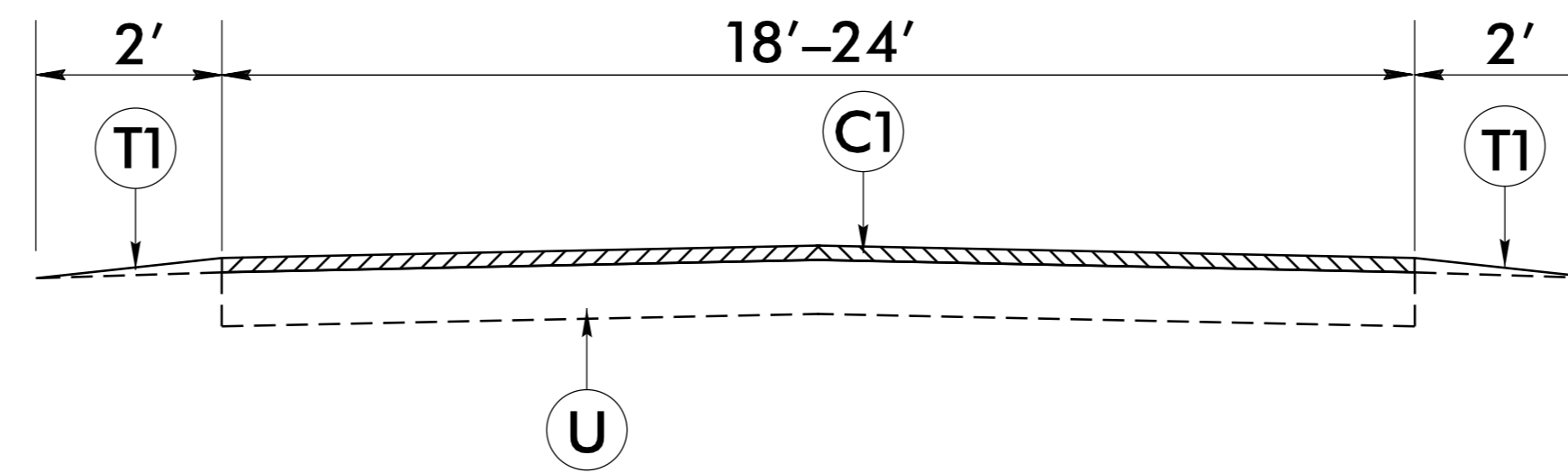

TYPICAL SECTION NO. 1

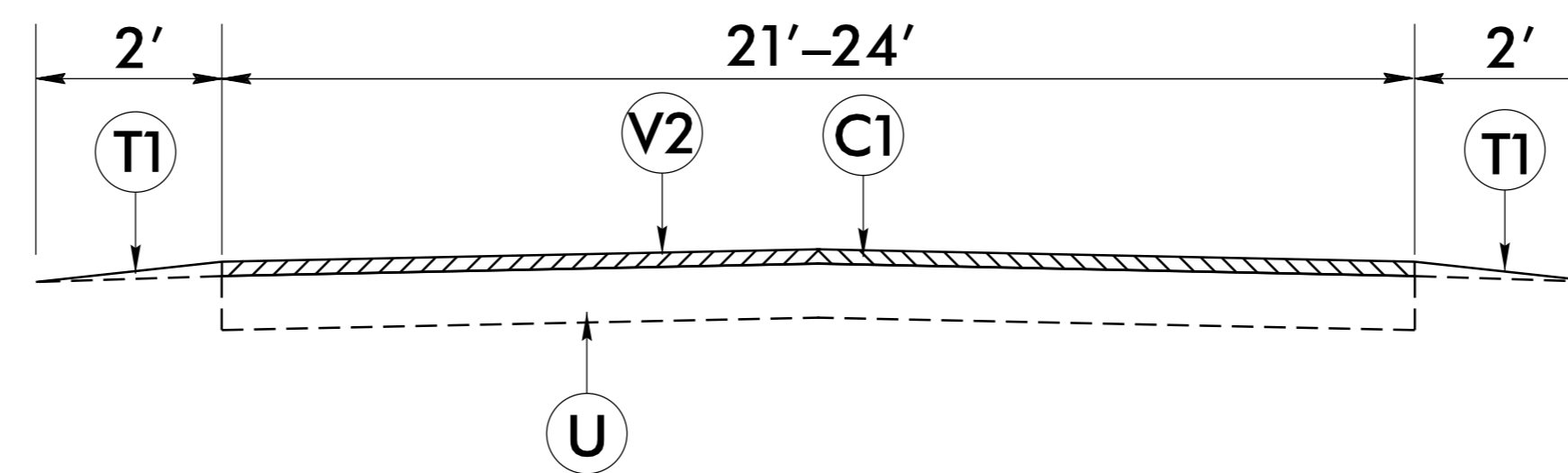

TYPICAL SECTION NO. 2

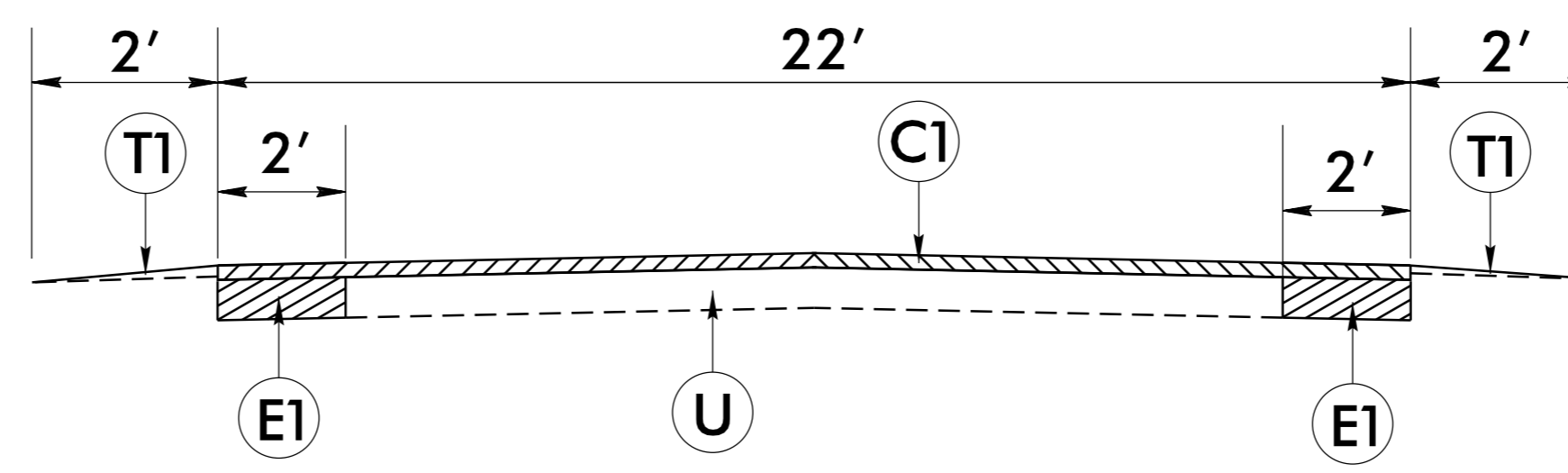

TYPICAL SECTION NO. 3

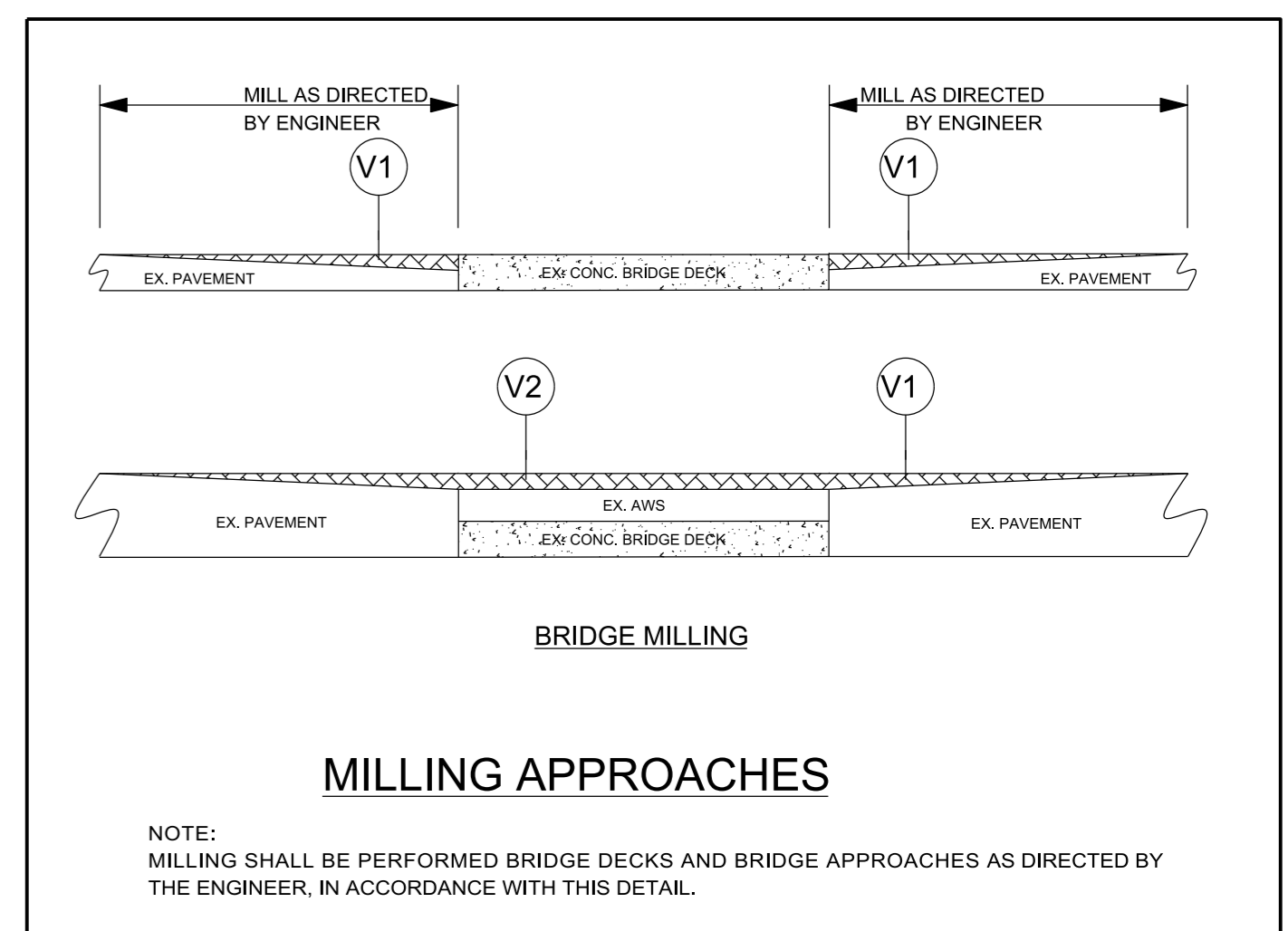

6/2/99  
 10-MAY-2023 09:47 AM  
 C:\Users\jstern\OneDrive\Documents\Projects\Resurfacing\2023 Spring\02\typ.dgn



- NOTES:
- 1) DETAIL DOES NOT APPLY TO OGAFD AND ULTRA-THIN BONDED WEARING COURSE.
  - 2) BACKFILL SHOULDER WITH APPROVED MATERIAL.
  - 3) THE SHOULDER WEDGE DEVICE MAY BE DISENGAGED AT PAVED DRIVEWAYS AND SIDE STREETS.

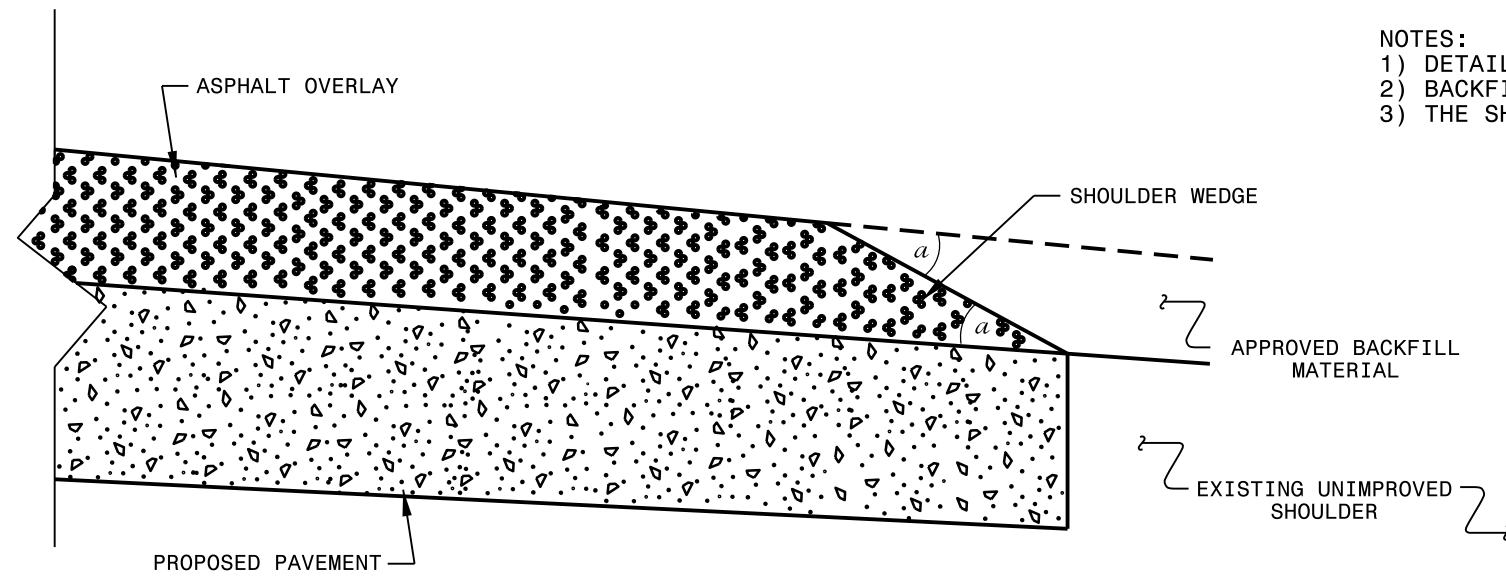

**SHOULDER WEDGE DETAIL**  
(Resurfacing Projects w/ Widening or  
with Existing Paved Shoulder having no dropoffs)

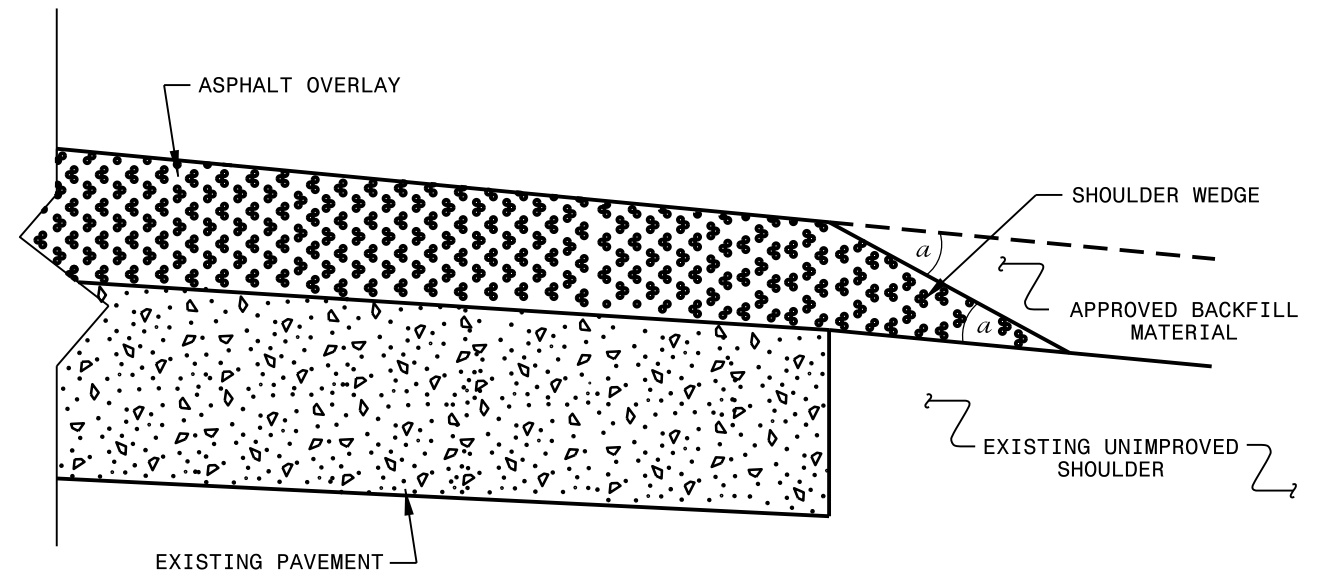

**SHOULDER WEDGE DETAIL**  
(Resurfacing Projects w/ NO Widening)

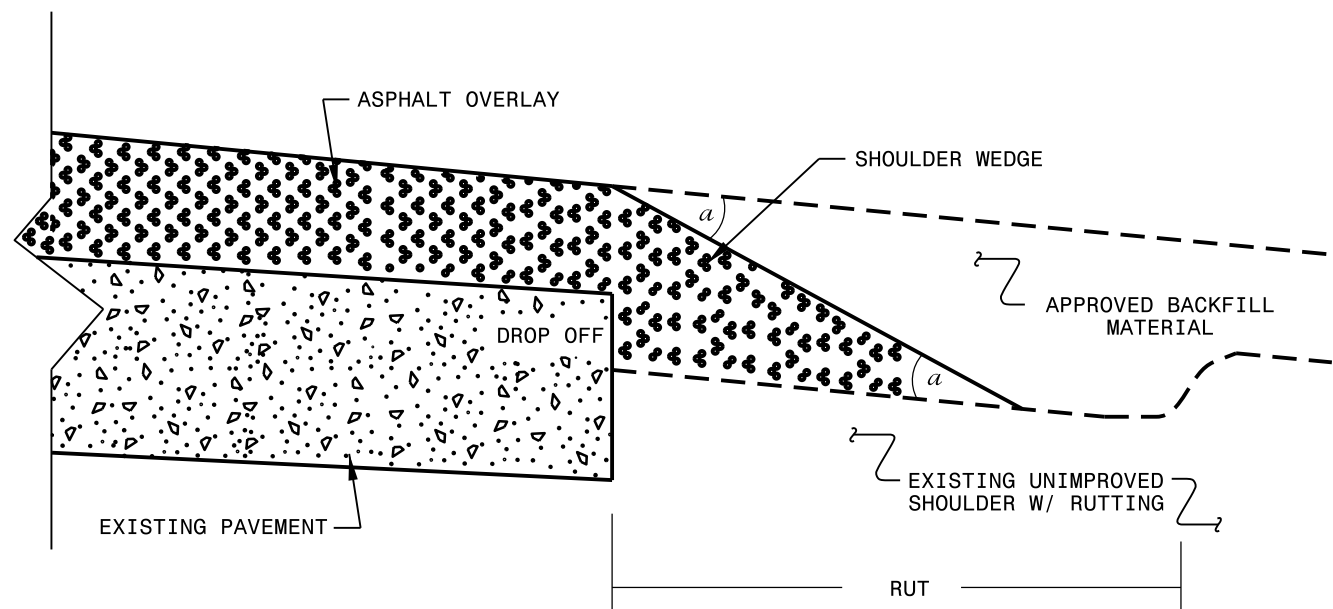

**SHOULDER WEDGE DETAIL**  
(Resurfacing Adjacent to  
Rutted Shoulder)

- SHOULDER WEDGE ANGLE = 30°

CONTRACT STANDARDS  
AND DEVELOPMENT UNIT  
Office 919-707-6950 FAX 919-250-4119

**SHOULDER WEDGE  
DETAILS**

ORIGINAL BY: T.SPELL DATE: 7-19-11  
MODIFIED BY: DATE: 10/16/12  
CHECKED BY: DATE:  
FILE SPEC.: susr/details/stand/shoulderwedgedetail.dgn

SYSTEMS DESIGN  
USER NAME

# SIGNING FOR RESURFACING PROJECTS

**LEGEND**

┃ STATIONARY SIGN

← DIRECTION OF TRAFFIC FLOW

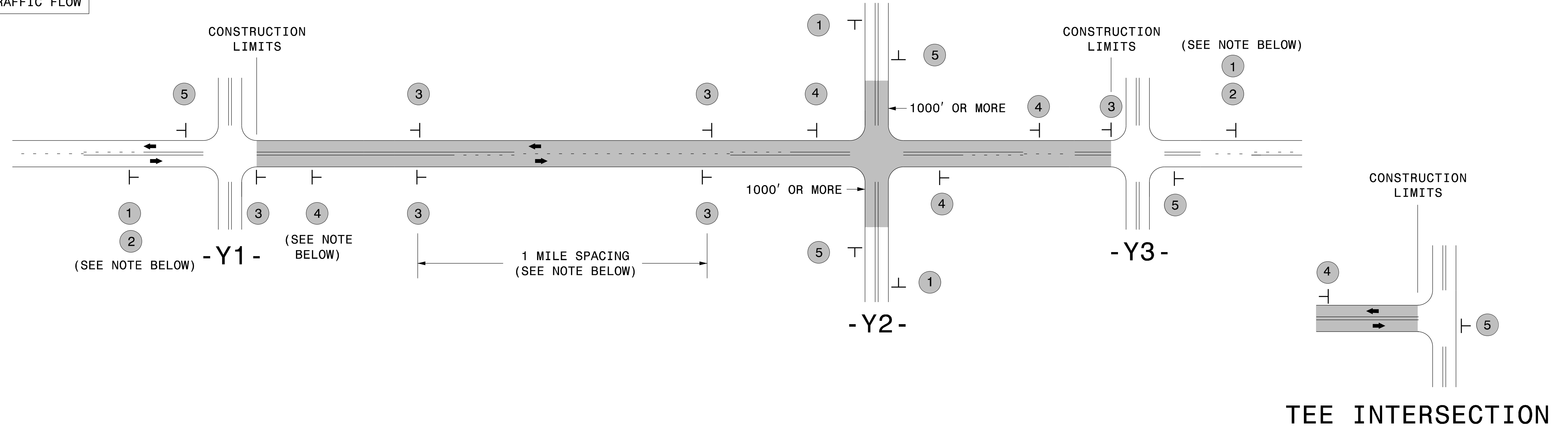

## MAINLINE (-L-) SIGNING

## -Y- LINE SIGNING

|   |  |  |   |
|---|--|--|---|
| SIGNING NOTES AND PLACEMENT PER DIRECTION |  | <p>PLACE 1000' PRIOR TO BEGINNING OF CONSTRUCTION LIMITS. ONLY USED ON -Y- LINES IF RESURFACING LIMITS EXTEND 1000' ALONG -Y- LINE.</p> <p>#2 SIGN ONLY USED WHEN CONSTRUCTION LIMITS ARE 2 OR MORE MILES IN LENGTH. ROUND UP TO NEXT WHOLE NUMBER. (NO FRACTIONAL OR DECIMAL NUMBERS)</p>   | <p>NO REQUIRED STATIONARY SIGNING FOR THE FOLLOWING -Y- LINE CONDITIONS:</p> <ol style="list-style-type: none"> <li>1) LESS THAN 1000' OF RESURFACING ALONG -Y- LINE</li> <li>2) SUBDIVISION ROADS</li> <li>3) DEAD END ROADS</li> </ol> <p>WHEN PAVING/CONSTRUCTION ACTIVITIES PROCEED ACROSS AN UNSIGNED -Y- LINE, PORTABLE ADVANCE WARNING SIGNS SHALL BE USED ALONG THE -Y- LINE AS SHOWN BELOW. REMOVE UPON COMPLETION OF WORK.</p> <div style="display: flex; justify-content: space-around;"> <div> <p>PLACED 500' IN ADVANCE OF FLAGGER.</p> </div> <div> <p>PLACED 250' IN ADVANCE OF FLAGGER.</p> </div> </div> |
|   |  |  |   |
|   |  | <p>- PLACE INITIALLY AT THE CONSTRUCTION LIMITS AND SPACE 1 MILE APART THEREAFTER.</p> <p>- AT TEE INTERSECTIONS INSTALL INITIALLY 1/2 MILE FROM INTERSECTION AND SPACE 1 MILE APART THEREAFTER.</p>   |   |
|   |  | <p>- THESE ARE FOR -Y- LINES THAT ARE "THROUGH" ROADWAYS.</p> <p>- DEAD END AND SUBDIVISION ROADS ARE NOT "THROUGH" ROADWAYS.</p> <p>- INSTALL 500' +/- FROM EACH -Y- LINE APPROACH AS SHOWN ABOVE.</p> <p>- FOR MULTIPLE -Y- LINES THAT ARE SEPARATED BY 0.25 MILES OR LESS, TREAT AS A SINGLE UNIT AND INSTALL WITHIN 500' OF EACH APPROACH.</p> <p>- A MAXIMUM OF 2 SIGN SETS PER MILE. DO NOT INSTALL WHEN -Y- LINES ARE WITHIN 0.5 MILES FROM "END ROAD WORK" SIGN.</p> <p>- FOR TEE INTERSECTIONS, INSTALL WITHIN 500' +/- OF THE INTERSECTION ALONG -L- LINE.</p> |   |
|   |  | <p>PLACE 500' FOLLOWING THE END OF CONSTRUCTION LIMITS OR AS SHOWN WHEN WORK ENDS AT A 3-WAY TEE INTERSECTION.</p>   |   |

THE ABOVE SIGNS ARE ALL THAT ARE REQUIRED FOR A CONTRACTOR TO BEGIN A RESURFACING CONTRACT. ANY ADDITIONAL SIGNS REQUESTED BY NCDOT DIVISIONS SHALL BE INSTALLED WITHIN 7 BUSINESS DAYS OF THE START OF CONTRACT WORK.

### MAPS LESS THAN 2 MILES

FOR RESURFACING MAPS WITH CONSTRUCTION LIMITS LESS THAN 2 MILES IN LENGTH, NO STATIONARY SIGNS ARE REQUIRED. USE PORTABLE "ROAD UNDER CONSTRUCTION" OR "ROAD WORK AHEAD" SIGNS IN LIEU OF STATIONARY ADVANCE WARNINGS SIGNS.

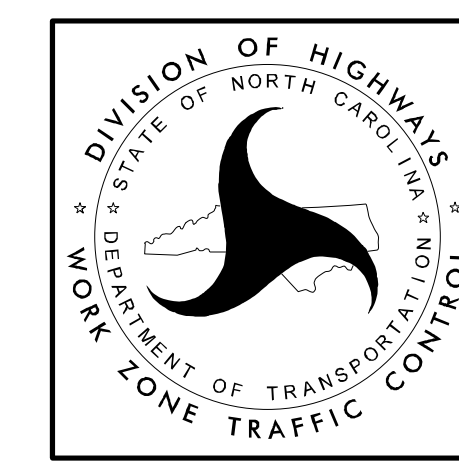

ADVANCE WARNING SIGNS FOR RURAL AND SUBURBAN 2-LANE ROADWAY RESURFACING

### High Speed Detection (≥40 mph)

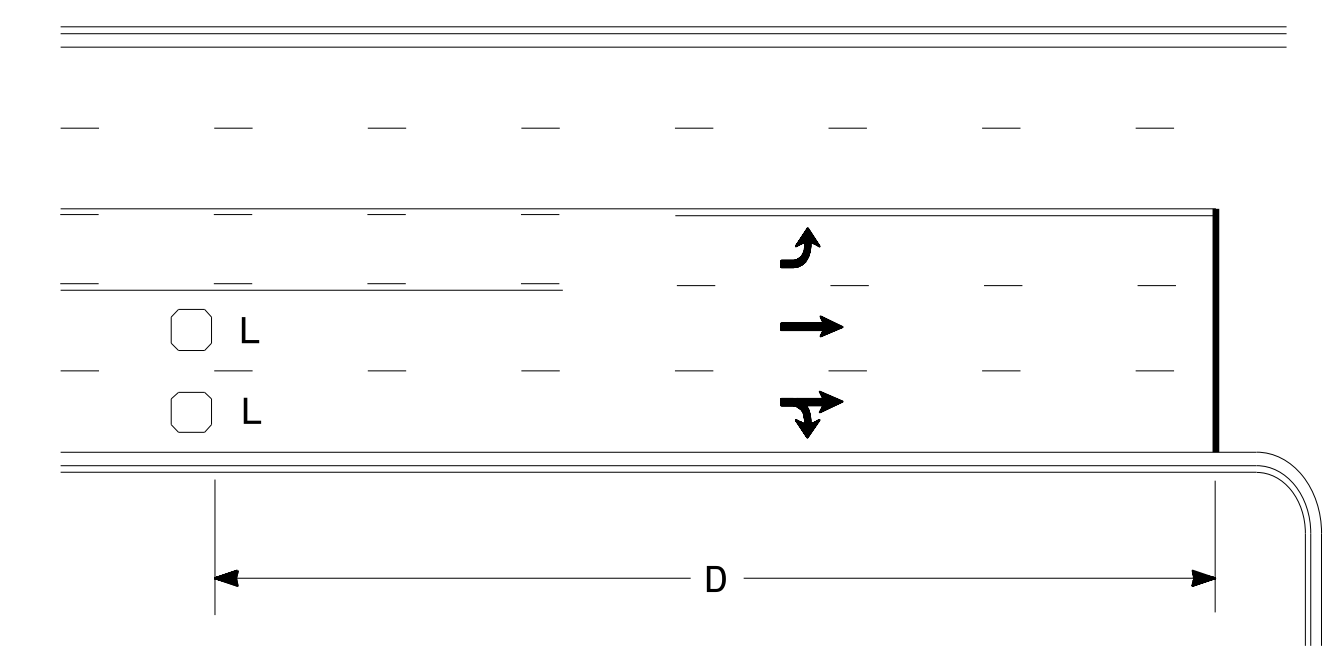

| Speed Limit<br>mph | D<br>ft |
|--------------------|---------|
| 40                 | 250     |
| 45                 | 300     |
| 50                 | 355     |
| 55                 | 420     |

L = 6ft X 6ft  
Wired in series for TS1  
Controllers  
Wired separately for TS2,  
170, and 2070L Controllers

Volume Density Operation

OR

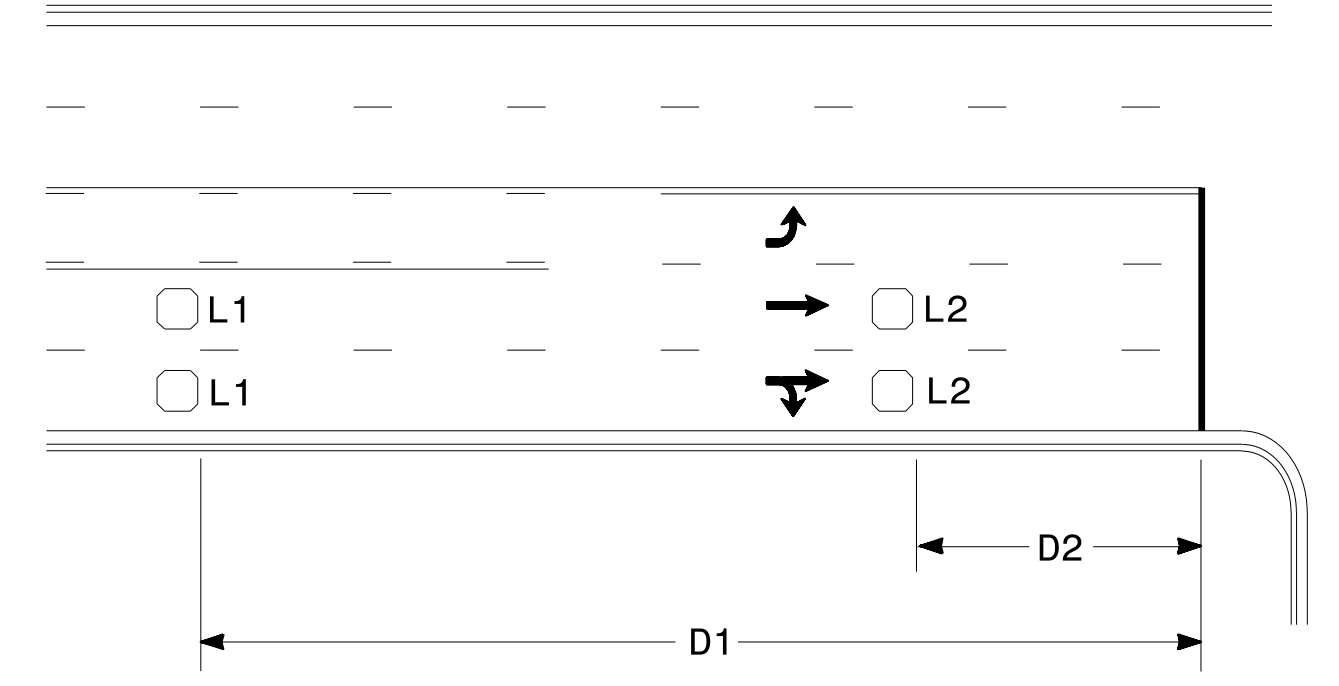

| Speed Limit<br>mph | D1<br>ft | D2<br>ft |
|--------------------|----------|----------|
| 40                 | 250      | 80       |
| 45                 | 300      | 90       |
| 50                 | 355      | 100      |
| 55                 | 420      | 110      |

L1 = 6ft X 6ft  
Wired in series  
L2 = 6ft X 6ft  
Wired in series

"Stretch" Operation

### Low Speed Detection (≤35 mph)

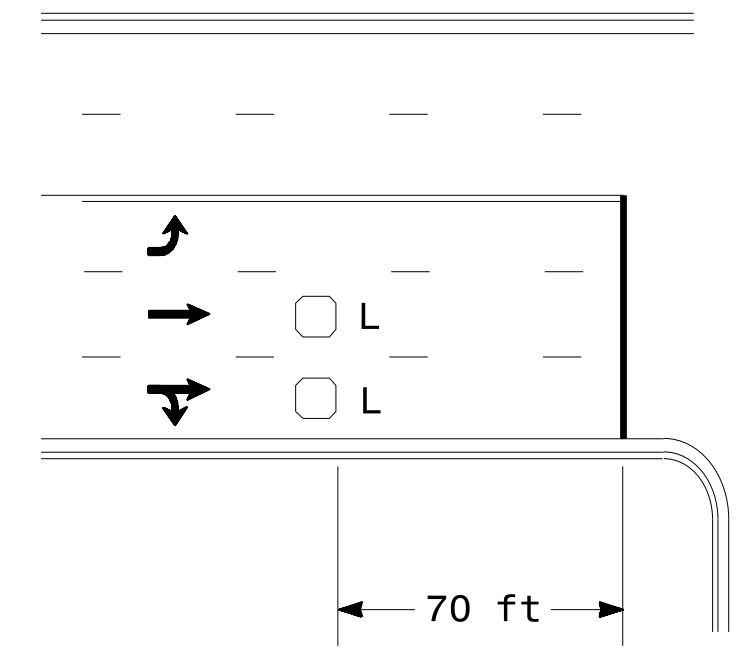

L = 6ft X 6ft  
Wired in series

OR

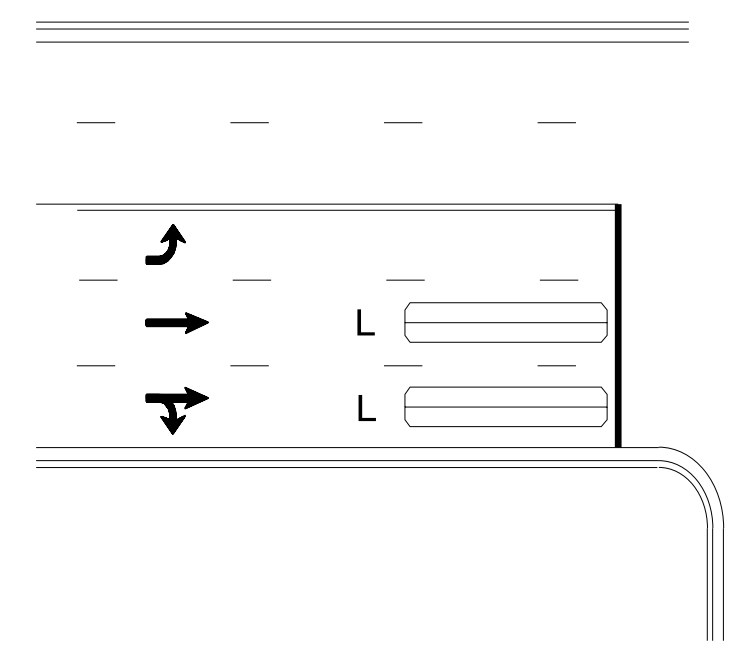

L = 6ft X 40ft  
Quadrupole loop, wired separately

### Left Turn Lane Detection

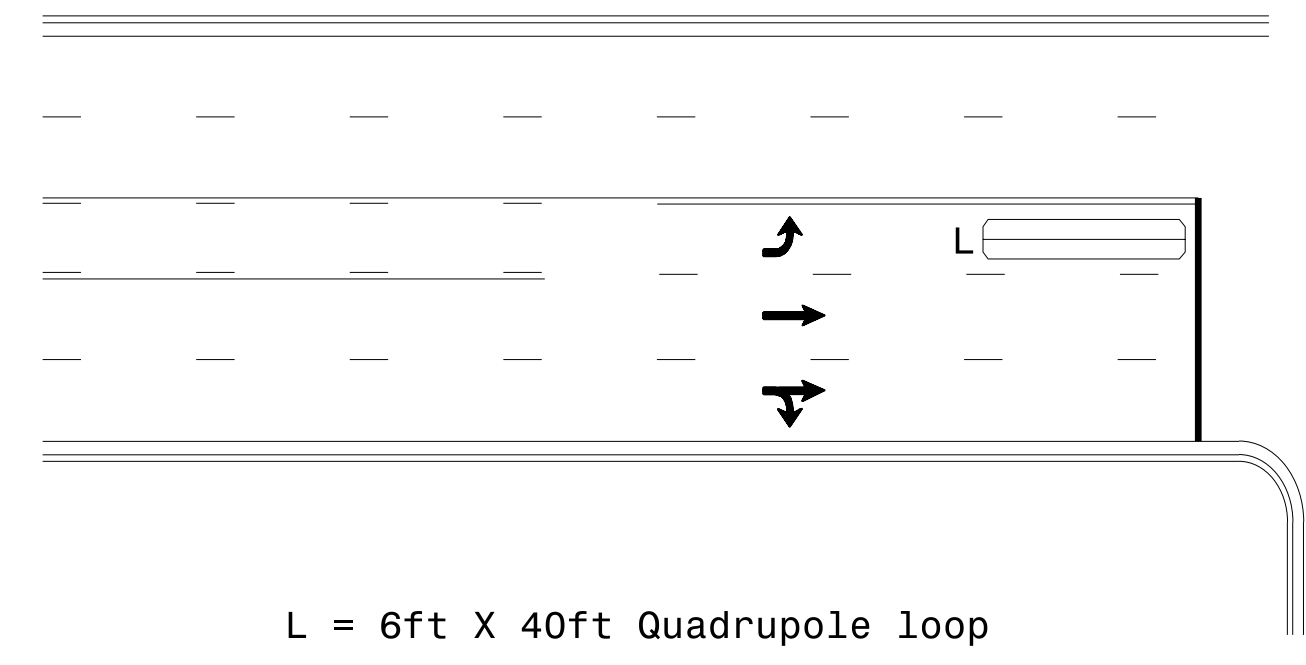

L = 6ft X 40ft Quadrupole loop

Presence Loop Detection

OR

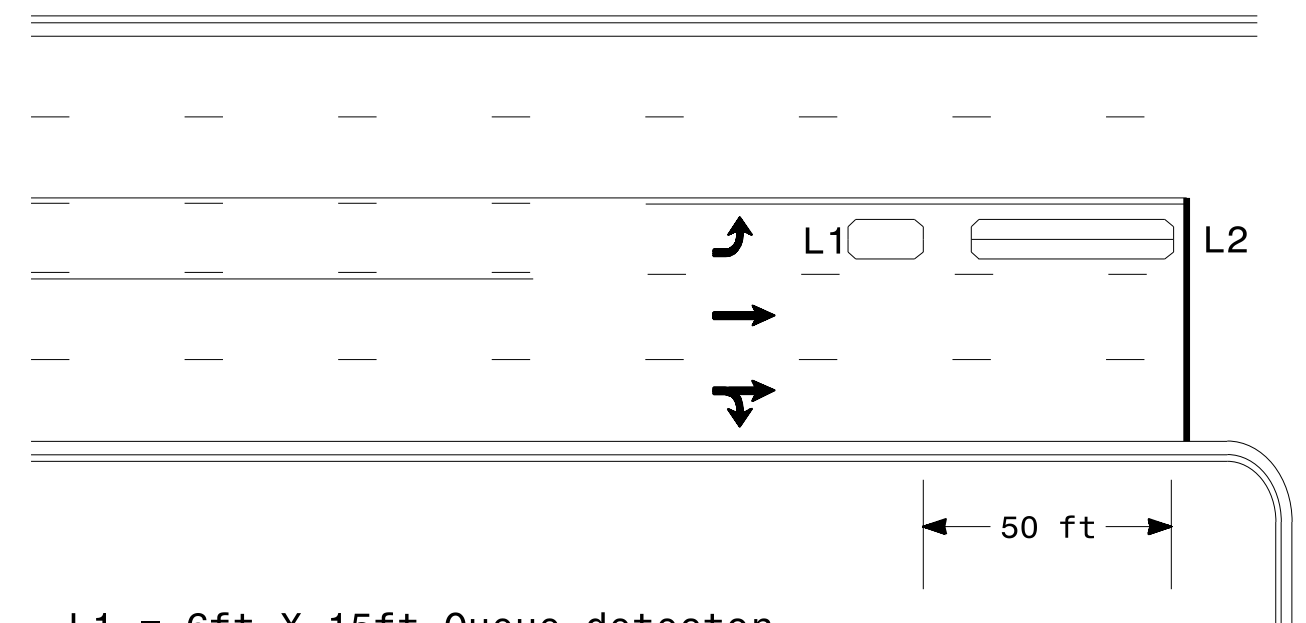

L1 = 6ft X 15ft Queue detector  
L2 = 6ft X 40ft Quadrupole loop

Queue Loop Detection

### Right Turn Lane Detection

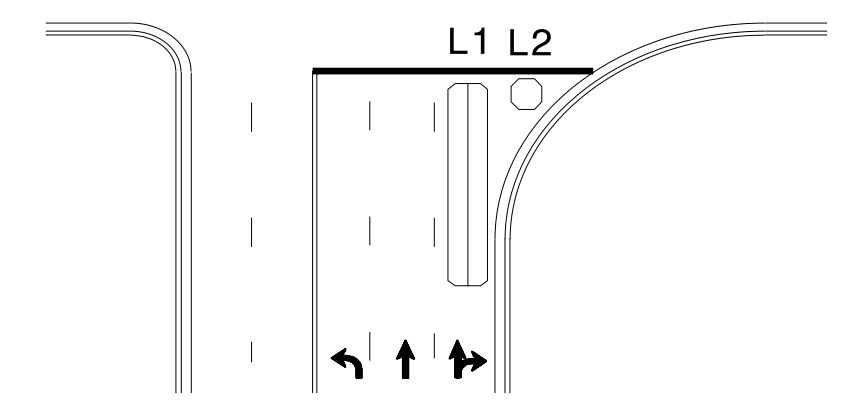

Shared Lane/  
Wide Radius Turn

L1 = 6ft X 40ft Quadrupole loop  
L2 = 6ft X 6ft [Minimum] Presence loop  
Wired separately

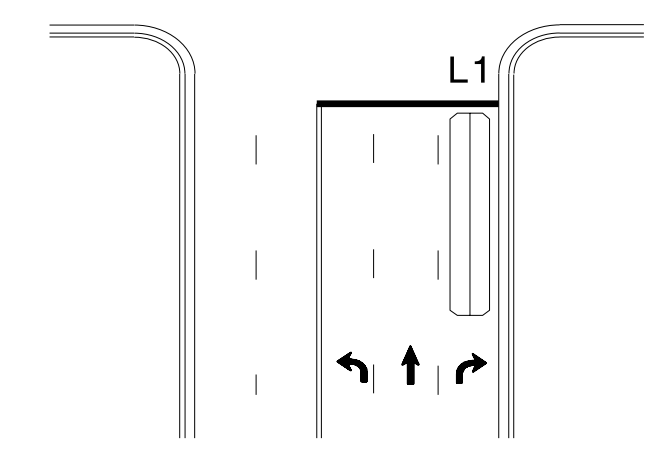

Standard Turn

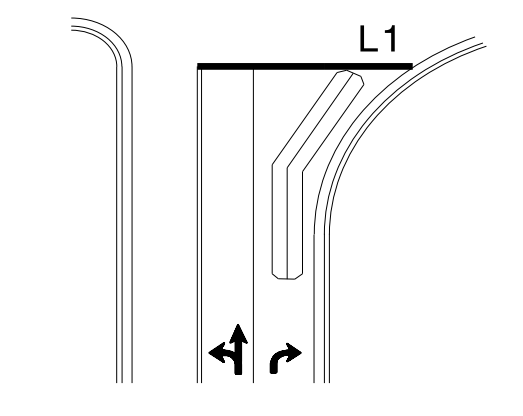

Wide Radius Turn

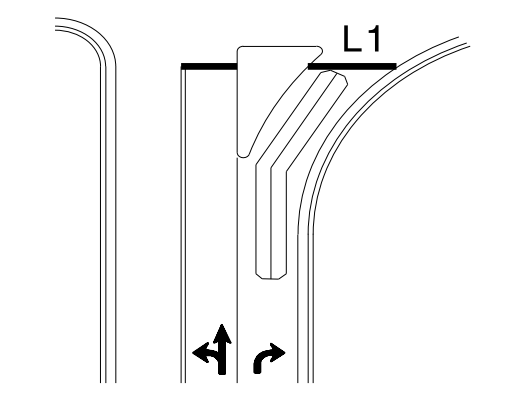

Channelized Turn

### Side Street Detection

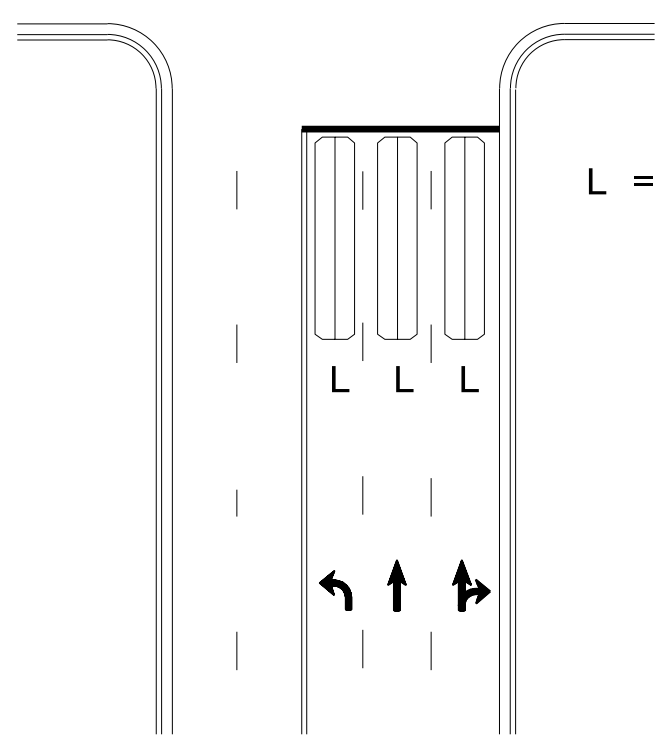

L = 6ft X 40ft  
Quadrupole loop  
Wired to separate  
detectors/channels

### Presence Loop Placement at Stop Lines

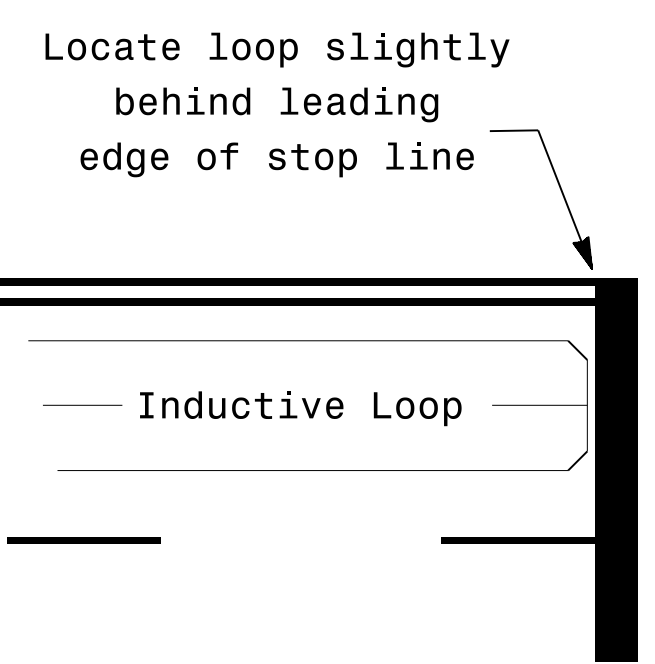

Locate loop slightly  
behind leading  
edge of stop line

Note:  
Loop may be located in advance  
of stop line under any of the  
following conditions:  
1) stop line is greater than 15'  
from edge of intersecting  
roadway  
2) loop detects a permissive or  
protected/permissive left turn  
3) for an exclusive right turn  
lane

### Recommended Number of Turns

Single 6' X 6' loop  
(when wired separately):

| Length of<br>Lead-in<br>ft | Number<br>of Turns |
|----------------------------|--------------------|
| < 250                      | 3                  |
| 250-375                    | 4                  |
| 375-525                    | 5                  |
| > 525                      | 6                  |

Quadrupole loops: Use 2-4-2 turns  
6' X 15' Loops:  
Lead-in < 150', use 2 turns  
Lead-in > 150', use 3 turns

|  |                                      |                         |  |
|--|--------------------------------------|-------------------------|--|
| <p>Prepared In the Offices of:<br/>TRANSPORTATION MOBILITY AND SAFETY SOLUTIONS, INC.<br/>SIGNAL DESIGN SECTION<br/>750 N. Greenfield Pkwy, Garner, NC 27529</p> | <p>Typical Signal Loop Locations</p> |                         | <p>SEAL<br/>NORTH CAROLINA<br/>PROFESSIONAL ENGINEER<br/>PAMELA L. ALEXANDER<br/>23489</p> |
|  | <p>PLAN DATE: January 2015</p>       | <p>REVIEWED BY: JPG</p> |  |
| <p>PREPARED BY: PLA</p>  | <p>REVIEWED BY:</p>                  | <p>REVISIONS</p>        | <p>INIT. DATE</p>  |
| <p>DocuSigned by:<br/>P. Alexander<br/>1/30/2015 10:44:44 AM</p>   |                                      |                         | <p>SIG. INVENTORY NO.</p>  |



### GUIDELINES FOR LANE WIDTHS ON RESURFACING PROJECTS

Contractor shall place the new pavement markings in accordance with this table and detail unless otherwise directed by the Engineer.

| <b>TWO LANE - TWO WAY ROADWAY - 55 MPH</b> |            |                |
|--|------------|----------------|
| ROADWAY WIDTH                              | LANE WIDTH | SHOULDER WIDTH |
| 18'  | 9' *       | 0'             |
| 20'  | 10' *      | 0'             |
| 22'  | 10'        | 1'             |
| 24'  | 10'        | 2'             |
| 26'  | 11'        | 2'             |
| 28'  | 12'        | 2'             |
| 32'  | 12'        | 4'             |

\* May vary due to pavement width

| <b>TWO LANE - TWO WAY ROADWAY</b> |            | <b>50</b>      |
|-----------------------------------|------------|----------------|
| <b>MPH OR LESS</b>                |            |                |
| ROADWAY WIDTH                     | LANE WIDTH | SHOULDER WIDTH |
| 18'                               | 9' *       | 0'             |
| 20'                               | 10' *      | 0'             |
| 22'                               | 10'        | 1'             |
| 24'                               | 10'        | 2'             |
| 26'                               | 11'        | 2'             |
| 28'                               | 11'        | 3'             |
| 32'                               | 11'        | 5'             |

\* May vary due to pavement width

### SCHEMATIC OF ROADWAY

(NOT TO SCALE)

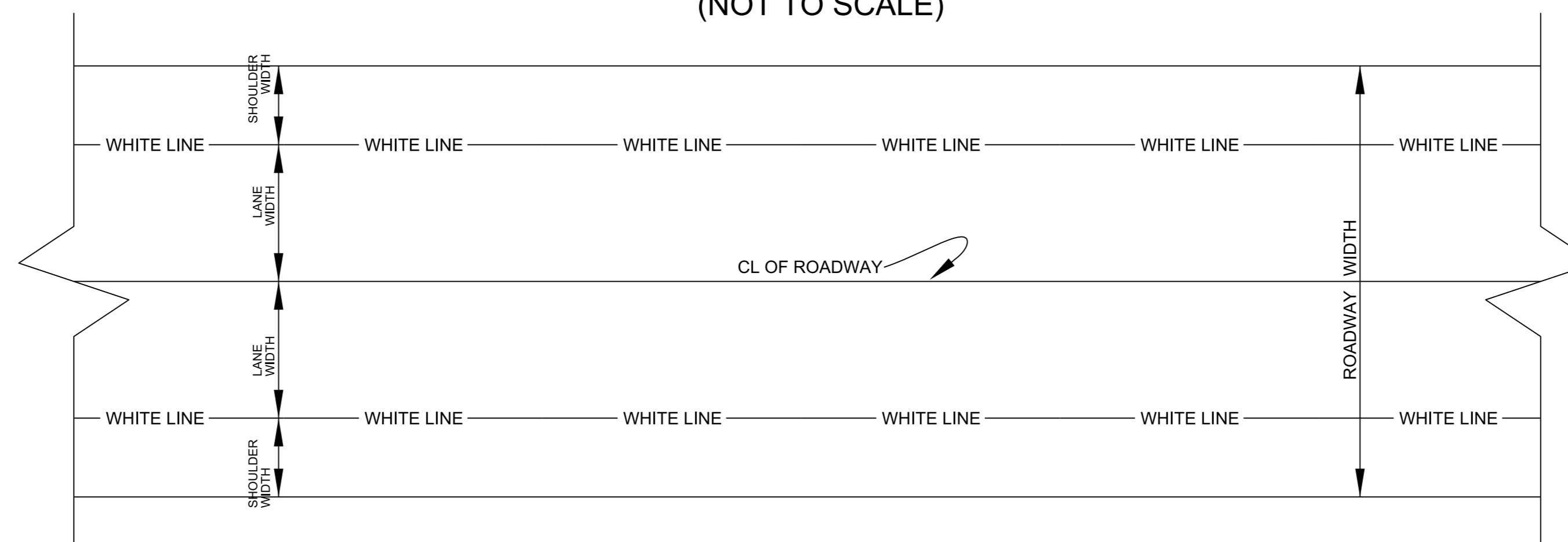

|                       |           |           |
|-----------------------|-----------|-----------|
| PROJECT NO.           | SHEET NO. | TOTAL NO. |
| 2023CPT.06.15.20431.1 |           |           |
|                       |           |           |

## SUMMARY OF QUANTITIES

| PROJECT NO                                      | COUNTY  | MAP NO | ROUTE                        | DESCRIPTION   | TYP NO | LANES | LANE TYPE | FINAL SURFACE TESTING REQUIRED | WARM MIX ASPHALT REQUIRED | LENGTH | WIDTH        | 1220000000-E          | 1245000000-E            | 1260000000-E              | 1297000000-E | 1330000000-E       | 1491000000-E        | 1519000000-E          | 1575000000-E                 | 1704000000-E               | 2845000000-N               |          |
|---|---------|--------|------------------------------|---|--------|-------|-----------|--------------------------------|---------------------------|--------|--------------|-----------------------|-------------------------|---------------------------|--------------|--------------------|---------------------|-----------------------|------------------------------|----------------------------|----------------------------|----------|
|   |         |        |                              |   |        |       |           |                                |                           |        |              | INCIDENTAL STONE BASE | SHOULDER RECONSTRUCTION | AGGREGATE SHOULDER BORROW | 1½" MILLING  | INCIDENTAL MILLING | BASE COURSE, B25.0C | SURFACE COURSE, S9.5B | ASPHALT BINDER FOR PLANT MIX | PATCHING EXISTING PAVEMENT | ADJ. OF METER OR VALVE BOX |          |
|   |         |        |                              |   |        |       |           |                                |                           |        |              | MI                    | FT                      | TONS                      | SMI          | TON                | SY                  | SY                    | TONS                         | TONS                       | TONS                       | EA       |
| 2023CPT.06.15.20431.1                           | Harnett | 1      | SR-1704 / TILGHMAN RD        | FROM SR 1709 TO SR 1703                                   | 1      | 2     | 2WU       | NO                             | NO                        | 1.89   | 20           | 37                    | 3.78                    | 611                       |              |                    |                     | 1,981                 | 134                          | 17                         |                            |          |
| <b>TOTAL FOR MAP NO. 1</b>                      |         |        |                              |   |        |       |           |                                |                           |        | <b>1.89</b>  | <b>37</b>             | <b>611</b>              |                           |              |                    | <b>1,981</b>        | <b>134</b>            | <b>17</b>                    |                            |                            |          |
| 2023CPT.06.15.20431.1                           | Harnett | 2      | SR-1746 / OLD POST RD        | FROM SR 1718 TO NC HWY 82                                 | 2      | 2     | 2WU       | NO                             | NO                        | 0.83   | 24           | 17                    | 1.66                    | 268                       | 11,686       | 278                |                     | 989                   | 66                           |                            |                            |          |
| <b>TOTAL FOR MAP NO. 2</b>                      |         |        |                              |   |        |       |           |                                |                           |        | <b>0.83</b>  |                       | <b>17</b>               | <b>1.66</b>               | <b>268</b>   | <b>11,686</b>      | <b>278</b>          |                       | <b>989</b>                   | <b>66</b>                  |                            |          |
| 2023CPT.06.15.20431.1                           | Harnett | 3      | SR-1808 / JONESBORO RD       | FROM JOHNSTON CO. LINE TO SR 1709                         | 2      | 2     | 2WU       | NO                             | NO                        | 1.35   | 21           | 32                    | 2.70                    | 437                       | 16,632       | 833                |                     | 1,446                 | 97                           |                            |                            |          |
| <b>TOTAL FOR MAP NO. 3</b>                      |         |        |                              |   |        |       |           |                                |                           |        | <b>1.35</b>  |                       | <b>32</b>               | <b>2.70</b>               | <b>437</b>   | <b>16,632</b>      | <b>833</b>          |                       | <b>1,446</b>                 | <b>97</b>                  |                            |          |
| 2023CPT.06.15.20431.1                           | Harnett | 4      | SR-1811 / BUD HAWKINS RD     | FROM US HWY 301 TO STIP I-5986A CONST. JT. - WEST OF I-95 | 1      | 2     | 2WU       | NO                             | NO                        | 0.39   | 24           | 2                     | 0.77                    | 125                       |              | 556                |                     | 498                   | 34                           | 2                          |                            |          |
| <b>TOTAL FOR MAP NO. 4</b>                      |         |        |                              |   |        |       |           |                                |                           |        | <b>0.39</b>  |                       | <b>2</b>                | <b>0.77</b>               | <b>125</b>   |                    | <b>556</b>          |                       | <b>498</b>                   | <b>34</b>                  | <b>2</b>                   |          |
| 2023CPT.06.15.20431.1                           | Harnett | 5      | SR-1811 / BUD HAWKINS RD     | FROM STIP I-5986A CONST. JT. - EAST OF I-95 TO SR 1002    | 3      | 2     | 2WU       | NO                             | NO                        | 1.16   | 18           | 30                    | 2.32                    | 375                       |              | 556                | 853                 | 1,509                 | 140                          | 8                          |                            |          |
| <b>TOTAL FOR MAP NO. 5</b>                      |         |        |                              |   |        |       |           |                                |                           |        | <b>1.16</b>  |                       | <b>30</b>               | <b>2.32</b>               | <b>375</b>   |                    | <b>556</b>          | <b>853</b>            | <b>1,509</b>                 | <b>140</b>                 | <b>8</b>                   |          |
| 2023CPT.06.15.20431.1                           | Harnett | 6      | SR-2006 / CRAWFORD RD        | FROM NC HWY 55 TO SR 1769                                 | 3      | 2     | 2WU       | NO                             | NO                        | 3.74   | 18           | 110                   | 7.48                    | 1,210                     |              | 833                | 2,752               | 4,781                 | 445                          | 18                         |                            |          |
| <b>TOTAL FOR MAP NO. 6</b>                      |         |        |                              |   |        |       |           |                                |                           |        | <b>3.74</b>  |                       | <b>110</b>              | <b>7.48</b>               | <b>1,210</b> |                    | <b>833</b>          | <b>2,752</b>          | <b>4,781</b>                 | <b>445</b>                 | <b>18</b>                  |          |
| 2023CPT.06.15.20431.1                           | Harnett | 7      | SR-2009 / PROSPECT CHURCH RD | FROM NC HWY 55 TO US HWY 421                              | 1      | 2     | 2WU       | NO                             | NO                        | 3.25   | 18           | 92                    | 6.50                    | 1,051                     |              | 556                |                     | 2,881                 | 194                          | 14                         |                            |          |
| <b>TOTAL FOR MAP NO. 7</b>                      |         |        |                              |   |        |       |           |                                |                           |        | <b>3.25</b>  |                       | <b>92</b>               | <b>6.50</b>               | <b>1,051</b> |                    | <b>556</b>          |                       | <b>2,881</b>                 | <b>194</b>                 | <b>14</b>                  |          |
| 2023CPT.06.15.20431.1                           | Harnett | 8      | SR-2011 / ERWIN CHAPEL RD    | FROM NC HWY 55 TO US HWY 421                              | 1      | 2     | 2WU       | NO                             | NO                        | 3.2    | 18           | 87                    | 6.40                    | 1,035                     |              | 556                |                     | 2,837                 | 191                          | 4                          |                            |          |
| <b>TOTAL FOR MAP NO. 8</b>                      |         |        |                              |   |        |       |           |                                |                           |        | <b>3.2</b>   |                       | <b>87</b>               | <b>6.40</b>               | <b>1,035</b> |                    | <b>556</b>          |                       | <b>2,837</b>                 | <b>191</b>                 | <b>4</b>                   |          |
| 2023CPT.06.15.20431.1                           | Harnett | 9      | SR-2026 / BYRDS POND RD      | FROM NC HWY 217 TO US HWY 401                             | 3      | 2     | 2WU       | NO                             | NO                        | 3.58   | 19           | 77                    | 7.16                    | 1,158                     |              | 278                | 2,634               | 4,703                 | 435                          | 4                          |                            |          |
| <b>TOTAL FOR MAP NO. 9</b>                      |         |        |                              |   |        |       |           |                                |                           |        | <b>3.58</b>  |                       | <b>77</b>               | <b>7.16</b>               | <b>1,158</b> |                    | <b>278</b>          | <b>2,634</b>          | <b>4,703</b>                 | <b>435</b>                 | <b>4</b>                   |          |
| 2023CPT.06.15.20431.1                           | Harnett | 10     | SR-2031 / WIRE RD            | FROM SR 2072 TO SR 2027                                   | 1      | 2     | 2WU       | NO                             | NO                        | 3.54   | 21.5         | 82                    | 7.08                    | 1,145                     |              | 833                |                     | 3,882                 | 263                          | 53                         | 3                          |          |
| <b>TOTAL FOR MAP NO. 10</b>                     |         |        |                              |   |        |       |           |                                |                           |        | <b>3.54</b>  |                       | <b>82</b>               | <b>7.08</b>               | <b>1,145</b> |                    | <b>833</b>          |                       | <b>3,882</b>                 | <b>263</b>                 | <b>53</b>                  | <b>3</b> |
| <b>TOTAL FOR PROJ NO. 2023CPT.06.15.20431.1</b> |         |        |                              |   |        |       |           |                                |                           |        | <b>22.93</b> |                       | <b>566</b>              | <b>45.85</b>              | <b>7,415</b> | <b>28,318</b>      | <b>5,279</b>        | <b>6,239</b>          | <b>25,507</b>                | <b>1,999</b>               | <b>120</b>                 | <b>3</b> |
| <b>GRAND TOTAL</b>                              |         |        |                              |   |        |       |           |                                |                           |        | <b>22.93</b> |                       | <b>566</b>              | <b>45.85</b>              | <b>7,415</b> | <b>28,318</b>      | <b>5,279</b>        | <b>6,239</b>          | <b>25,507</b>                | <b>1,999</b>               | <b>120</b>                 | <b>3</b> |

|                       |           |           |
|-----------------------|-----------|-----------|
| PROJECT NO.           | SHEET NO. | TOTAL NO. |
| 2023CPT.06.15.20431.1 |           |           |

## THERMOPLASTIC AND PAINT QUANTITIES

| PROJECT NO                                      | COUNTY  | MAP NO | ROUTE                        | DESCRIPTION   | TYP NO | LANES | LANE TYPE | LENGTH | WIDTH | 4413000000-E                                       | 4457000000-N                    | 4685000000-E                 |                               | 4695000000-E                 | 4709000000-E                  | 4720000000-E                 | 4725000000-E               | 4891000000-E   | 4900000000-N                  |                          |            |              |           |
|---|---------|--------|------------------------------|---|--------|-------|-----------|--------|-------|--|---------------------------------|------------------------------|-------------------------------|------------------------------|-------------------------------|------------------------------|----------------------------|--|-------------------------------|--------------------------|------------|--------------|-----------|
|   |         |        |                              |   |        |       |           |        |       | WORK ZONE<br>ADVANCE/GENERAL<br>WARNING<br>SIGNING | TEMPORARY<br>TRAFFIC<br>CONTROL | 4" X 90 M<br>WHITE<br>THERMO | 4" X 90 M<br>YELLOW<br>THERMO | 8" X 90 M<br>WHITE<br>THERMO | 24" X 90 M<br>WHITE<br>THERMO | THERMO<br>MSG SCHOOL<br>90 M | THERMO RT<br>ARROW 90<br>M | GENERIC<br>MARKING, 4"<br>X 90 M WHITE<br>THERMO (SKIP<br>& MINI SKIP) | YELLOW &<br>YELLOW<br>MARKERS | CRYSTAL &<br>RED MARKERS |            |              |           |
|   |         |        |                              |   |        |       |           | MI     | FT    | SF   | LS                              | LF                           | LF                            | LF                           | LF                            | EA                           | EA                         | LF   | EA                            | EA                       |            |              |           |
| 2023CPT.06.15.20431.1                           | Harnett | 1      | SR-1704 / TILGHMAN RD        | FROM SR 1709 TO SR 1703                                   | 1      | 2     | 2WU       | 1.89   | 20    | 212  | 1.00                            | 19,958                       | 16,964                        |                              |                               |                              |                            |  | 125                           |                          |            |              |           |
| <b>TOTAL FOR MAP NO. 1</b>                      |         |        |                              |   |        |       |           |        |       |  |                                 | <b>1.89</b>                  | <b>212</b>                    | <b>1</b>                     | <b>19,958</b>                 | <b>16,964</b>                |                            |  | <b>125</b>                    |                          |            |              |           |
| 2023CPT.06.15.20431.1                           | Harnett | 2      | SR-1746 / OLD POST RD        | FROM SR 1718 TO NC HWY 82                                 | 2      | 2     | 2WU       | 0.83   | 24    | 93   |                                 | 8,765                        | 7,452                         | 320                          |                               | 3                            |                            | 100  | 60                            | 15                       |            |              |           |
| <b>TOTAL FOR MAP NO. 2</b>                      |         |        |                              |   |        |       |           |        |       |  |                                 | <b>0.83</b>                  | <b>93</b>                     |                              | <b>8,765</b>                  | <b>7,452</b>                 | <b>320</b>                 |  | <b>3</b>                      | <b>100</b>               | <b>60</b>  | <b>15</b>    |           |
| 2023CPT.06.15.20431.1                           | Harnett | 3      | SR-1808 / JONESBORO RD       | FROM JOHNSTON CO. LINE TO SR 1709                         | 2      | 2     | 2WU       | 1.35   | 21    | 151  |                                 | 14,256                       | 12,117                        |                              |                               |                              |                            |  | 90                            |                          |            |              |           |
| <b>TOTAL FOR MAP NO. 3</b>                      |         |        |                              |   |        |       |           |        |       |  |                                 | <b>1.35</b>                  | <b>151</b>                    |                              | <b>14,256</b>                 | <b>12,117</b>                |                            |  |                               | <b>90</b>                |            |              |           |
| 2023CPT.06.15.20431.1                           | Harnett | 4      | SR-1811 / BUD HAWKINS RD     | FROM US HWY 301 TO STIP I-5986A CONST. JT. - WEST OF I-95 | 1      | 2     | 2WU       | 0.39   | 24    | 43   |                                 | 4,118                        | 3,500                         |                              |                               |                              |                            |  | 26                            |                          |            |              |           |
| <b>TOTAL FOR MAP NO. 4</b>                      |         |        |                              |   |        |       |           |        |       |  |                                 | <b>0.39</b>                  | <b>43</b>                     |                              | <b>4,118</b>                  | <b>3,500</b>                 |                            |  |                               | <b>26</b>                |            |              |           |
| 2023CPT.06.15.20431.1                           | Harnett | 5      | SR-1811 / BUD HAWKINS RD     | FROM STIP I-5986A CONST. JT. - EAST OF I-95 TO SR 1002    | 3      | 2     | 2WU       | 1.16   | 18    | 130  |                                 | 12,250                       | 10,412                        |                              |                               |                              |                            |  | 77                            |                          |            |              |           |
| <b>TOTAL FOR MAP NO. 5</b>                      |         |        |                              |   |        |       |           |        |       |  |                                 | <b>1.16</b>                  | <b>130</b>                    |                              | <b>12,250</b>                 | <b>10,412</b>                |                            |  |                               | <b>77</b>                |            |              |           |
| 2023CPT.06.15.20431.1                           | Harnett | 6      | SR-2006 / CRAWFORD RD        | FROM NC HWY 55 TO SR 1769                                 | 3      | 2     | 2WU       | 3.74   | 18    | 419  |                                 | 39,494                       | 33,570                        |                              |                               |                              |                            |  | 250                           |                          |            |              |           |
| <b>TOTAL FOR MAP NO. 6</b>                      |         |        |                              |   |        |       |           |        |       |  |                                 | <b>3.74</b>                  | <b>419</b>                    |                              | <b>39,494</b>                 | <b>33,570</b>                |                            |  |                               | <b>250</b>               |            |              |           |
| 2023CPT.06.15.20431.1                           | Harnett | 7      | SR-2009 / PROSPECT CHURCH RD | FROM NC HWY 55 TO US HWY 421                              | 1      | 2     | 2WU       | 3.25   | 18    | 364  |                                 | 34,320                       | 29,172                        |                              |                               |                              |                            |  | 215                           |                          |            |              |           |
| <b>TOTAL FOR MAP NO. 7</b>                      |         |        |                              |   |        |       |           |        |       |  |                                 | <b>3.25</b>                  | <b>364</b>                    |                              | <b>34,320</b>                 | <b>29,172</b>                |                            |  |                               | <b>215</b>               |            |              |           |
| 2023CPT.06.15.20431.1                           | Harnett | 8      | SR-2011 / ERWIN CHAPEL RD    | FROM NC HWY 55 TO US HWY 421                              | 1      | 2     | 2WU       | 3.2    | 18    | 358  |                                 | 33,792                       | 28,723                        |                              | 100                           | 12                           |                            |  | 215                           |                          |            |              |           |
| <b>TOTAL FOR MAP NO. 8</b>                      |         |        |                              |   |        |       |           |        |       |  |                                 | <b>3.2</b>                   | <b>358</b>                    |                              | <b>33,792</b>                 | <b>28,723</b>                |                            | <b>100</b>   | <b>12</b>                     |                          | <b>215</b> |              |           |
| 2023CPT.06.15.20431.1                           | Harnett | 9      | SR-2026 / BYRDS POND RD      | FROM NC HWY 217 TO US HWY 401                             | 3      | 2     | 2WU       | 3.58   | 19    | 401  |                                 | 37,804                       | 32,133                        |                              |                               |                              |                            |  | 240                           |                          |            |              |           |
| <b>TOTAL FOR MAP NO. 9</b>                      |         |        |                              |   |        |       |           |        |       |  |                                 | <b>3.58</b>                  | <b>401</b>                    |                              | <b>37,804</b>                 | <b>32,133</b>                |                            |  |                               | <b>240</b>               |            |              |           |
| 2023CPT.06.15.20431.1                           | Harnett | 10     | SR-2031 / WIRE RD            | FROM SR 2072 TO SR 2027                                   | 1      | 2     | 2WU       | 3.54   | 21.5  | 396  |                                 | 37,382                       | 31,774                        | 125                          | 75                            |                              |                            |  | 240                           |                          |            |              |           |
| <b>TOTAL FOR MAP NO. 10</b>                     |         |        |                              |   |        |       |           |        |       |  |                                 | <b>3.54</b>                  | <b>396</b>                    |                              | <b>37,382</b>                 | <b>31,774</b>                | <b>125</b>                 | <b>75</b>  |                               | <b>240</b>               |            |              |           |
| <b>TOTAL FOR PROJ NO. 2023CPT.06.15.20431.1</b> |         |        |                              |   |        |       |           |        |       |  |                                 | <b>22.93</b>                 | <b>2,567</b>                  | <b>1.000</b>                 | <b>242,139</b>                | <b>205,817</b>               | <b>445</b>                 | <b>175</b>   | <b>12</b>                     | <b>3</b>                 | <b>100</b> | <b>1,538</b> | <b>15</b> |
|   |         |        |                              |   |        |       |           |        |       |  |                                 | <b>447,956</b>               |                               |                              |                               |                              |                            |  |                               | <b>1,553</b>             |            |              |           |